

INSTALLATION INSTRUCTIONS

COMMERCIAL DIVISION
NETWORK TECHNICAL INFORMATION

FITTING THE AFTERMARKET BOA ANTI-THEFT DEVICE TO AN ELYSEO

Parts necessary:

1 kit ref 05541 comprising:

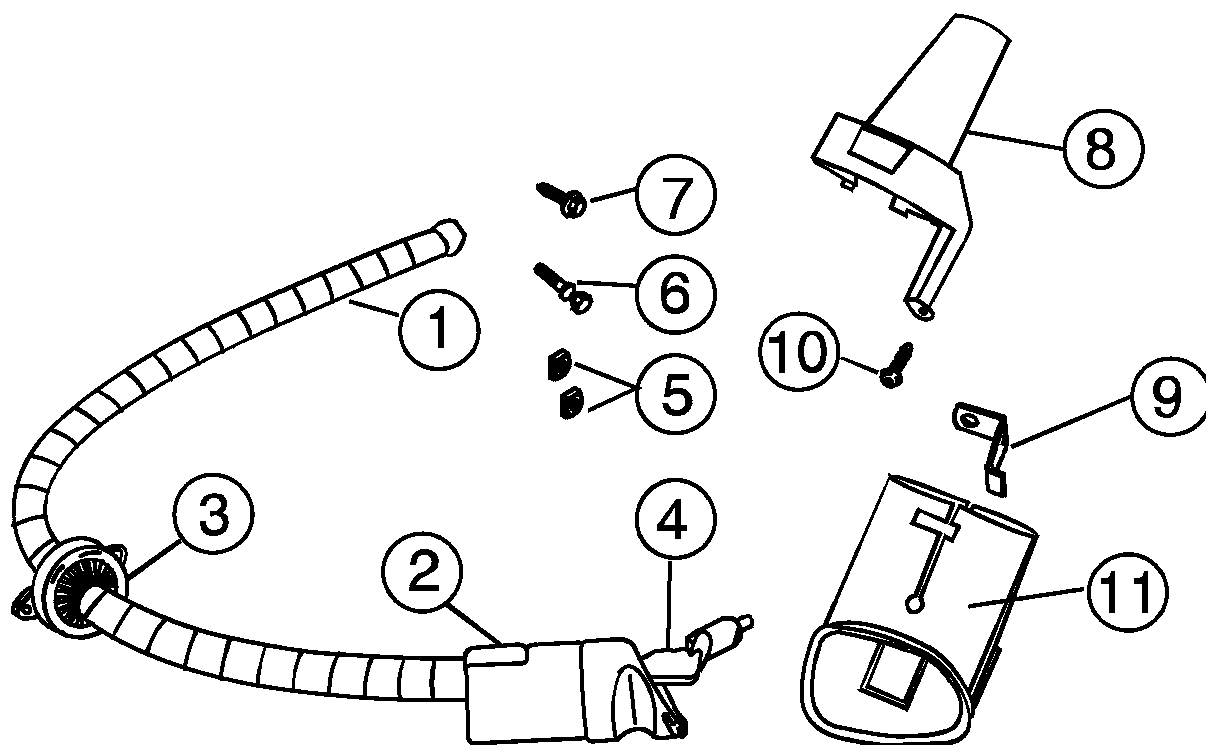

1- boa anti-theft device ref: 738849
comprising:

2- locking system

3- frame end

4- set of keys

5- square nuts (2) ref: 714938

6- shear screw ref: 719921

7- collar screw ref: 726979

8- casing ref: 738865

9- securing bracket ref: 738850

10- screw (1) ref: 728540

11- cover ref: 737384

Disassembly:

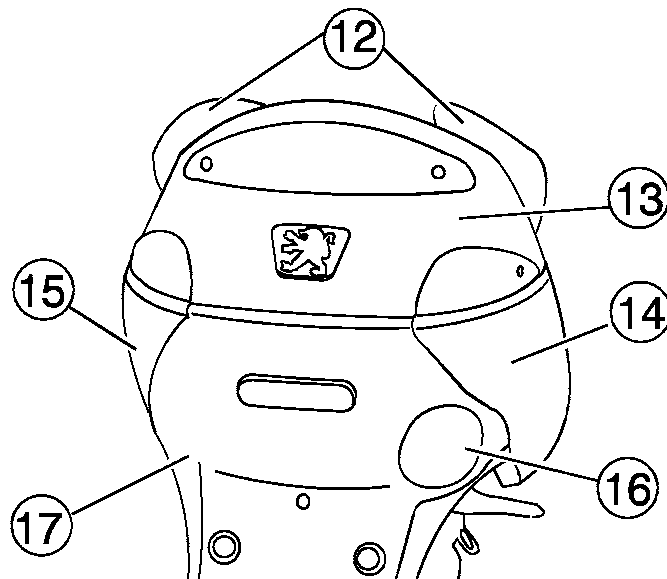

Remove the 2 handles (12) (4 screws)

Remove the rear fairing (13) (2 screws) put it in the locker without disconnecting it

Remove the rear right (14) and left (15) fairings (6 screws)

Remove the BOA plug (16) from the rear mudguard

Remove the rear mudguard (17) (5 screws)

Reassembly:

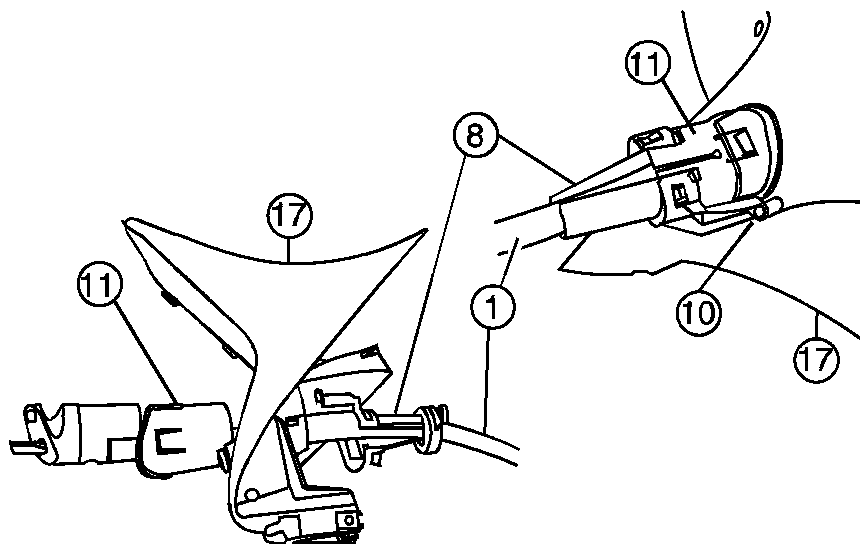

Clip the locking tab (9) into the cover (11)

Make up the assembly in the rear mudguard (17) with the cover (11) and the casing (8) on the BOA (1) fix the assembly in the mudguard with screw (10)

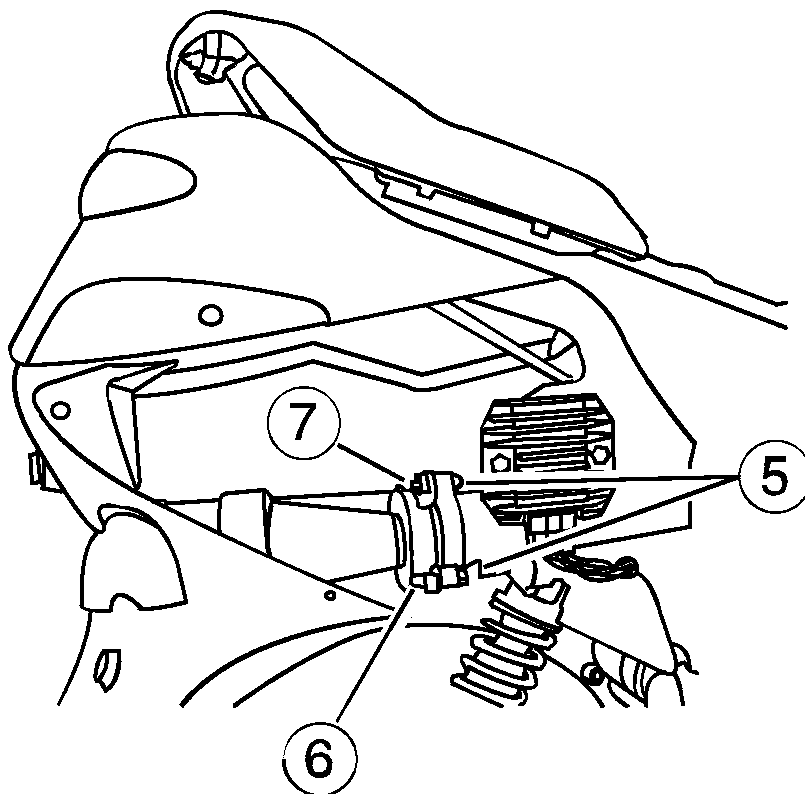

Position the assembly on the machine (5 screws for the mudguard) and fix the BOA to the chassis with the 2 screws (6) and (7), one of which is the shear screw and the nuts (5)

Clip on and refit the right and left fairings (6 screws)

Refit the rear fairing (2 screws)

Refit the 2 handles (4 screws)